

Snow Machine Consumer Model USER MANUAL



The Consumer Snow Machine is a home version of the special effects machines used for years in movie productions, theaters, malls and high end exhibits. The Consumer Snow Machine sprays specially formulated evaporative snow and creates a unique snowfall effect without cold air or cleanup required. This device can be the centerpiece of outdoor holiday arrangements in almost any environment.

The Consumer Snow Machine is recommended for outdoor usage.

Important Product & Safety Information:

Failure to follow these instructions could cause serious bodily injury or property damage.

These instructions pertain to a risk of fire, electric shock or injury to persons.

Warning: You must read the following before operating this device.

The Consumer Snow Machine is an electrical product, not a toy. To avoid the risk of fire, burns, personal injury and electric shock, **it should not be used in a manner for which it was not designed and should be placed out of reach of small children.** Competent adult supervision is necessary to avoid the risk of electric shock or personal injury.

This device sprays evaporative snow that dissipates easily when sprayed from 15 to 20 ft. in the air. The Consumer Snow Machine may be positioned at ground level; however there is a chance for some build-up of slippery residue on some ground surfaces (linoleum in particular.) Use caution in determining the locations for the Incredible Consumer Snow Machine and warn passers-by of potential slippery

- **Never operate the Consumer Snow Machine without liquid solution SMF-1C & water, in the machine tank. Do not operate the Consumer Snow Machine when the machine tank contains a pint or less of solution. If you do not follow these directions, the device may be damaged.**
- Always operate the Consumer Snow Machine on a dry, even surface away from a ledge or steps to prevent any falling hazards or slippery conditions.
- Never leave the device unattended while operating. Do not operate in the rain or near standing water.
- Always use an outlet with an earth grounded receptacle and a ground fault circuit interrupter
- (GFCI.) Never operate the device with a frayed electrical wire. Do not use in extreme heat or cold.
- Never use this product for any activity other than it was designed for.

Save these directions.

Warning: When using electric appliances, basic precautions should always be followed, including the following:

1. Read all instructions before using the appliance
2. To reduce risk of injury, close supervision is necessary when an appliance is used near children.
3. Do not make contact with moving parts during operation.
4. Only use attachments recommended or sold by the manufacturer.
5. For a cord-connected appliance, the following shall be included:
 - a. To disconnect, turn all controls to the off position, then remove plug from the outlet.
 - b. Do not unplug by pulling on the cord. To unplug, grasp the plug, not the cord.
 - c. Unplug from outlet when not in used and before servicing or cleaning.
 - d. Do not operate any appliance with a damaged cord or plug, after the appliance malfunctions, is dropped or damaged in any manner. Seek evaluation at the nearest authorized services facility for repair or electrical or mechanical adjustment.
6. To reduce the risk of electrical shock, do not put the Consumer Snow Machine in water or other liquids. Do not

| | |
|---------------------------|---|
| Voltage: | 120v 60Hz |
| Fuse: | 10 Amps |
| Size: | 11" x 13" x15" (l, w, h) |
| Weight: | 11 lbs. |
| Materials: | ABS, PSA, & PE |
| Snow Solution Usage Rate: | 1.5-2 oz. Solution Mixture per minute (approximate) |
| Cable Length: | 70 in |

General Operating Instructions:

In order to create a beautiful and entertaining evaporative snowfall, ensure the safety of the operators/participants and protect the equipment from damage. Please follow these instructions carefully.

1. Always prepare your snowfall area; making sure it is dry and free of obstructions. Note that if the snowfall surface area is linoleum or smooth, the floor may become slippery.
2. Locate the Consumer Snow Machine on a secure, dry, and level surface then rotate the Consumer Snow Machine so that the desired direction of snowfall is achieved. Keep the Consumer Snow Machine unplugged from the electrical outlet while placing the Consumer Snow Machine in your desired location. Do not operate the Consumer Snow Machine from a wet surface.

3. Prepare the snow solution in the plastic container built in. (See: image below.) Fill the container with water. Then add one 3oz of snow solution concentrate. If the water/concentrate is not blended properly, the snow machine will not create the ideal evaporative snowflakes.

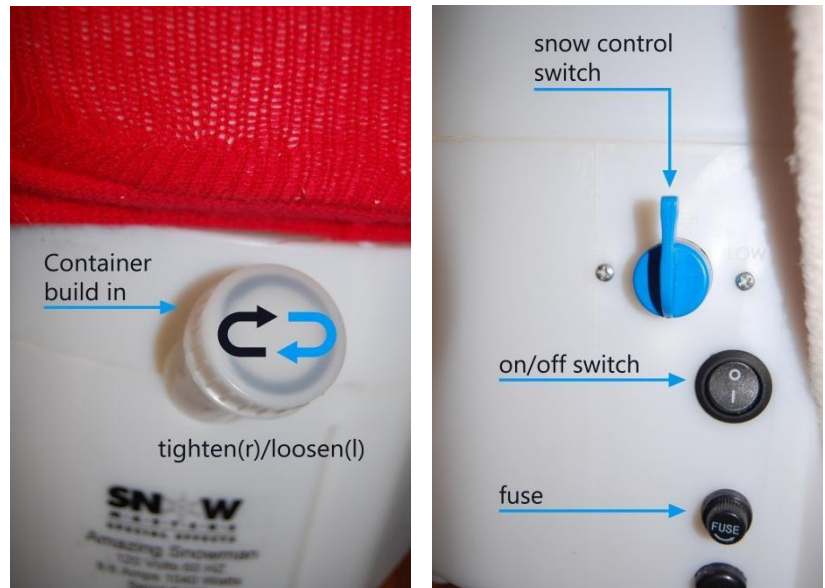

4. Turn the cap to the container in a clockwise direction and tighten.
5. Connect hose to machine. Hose is sometimes spiraled loose in box and not clamped to the machine.
6. In order to start the Consumer Snow Machine simply press the red button on the side of the unit to the "I" or open position and your Consumer Snow Machine will start (allow ~30 second for the pump to prime and for snow production.)
7. If the solution has drained out of the clear tube during a rest period for the Consumer Snow Machine, it may take ~1-2 minutes for the pump to self-prime the solution from the container liquid.
8. There is a control switch above the power switch of the snow machine that allows you to adjust the snowfall amount. The snow should come out in a light flurry in order to evaporate properly. A heavier snowfall will tend to accumulate on the ground causing slippery conditions.
9. If the snow is not generating properly after several uses, remove the snow sock at the end of the hose by removing the plastic tie [zip-tie] and rinse under warm water and replace (using new plastic tie [zip-tie] provided.)

Remember; do not let the machine run with a very low or empty tank as this can damage the pump. The pump does not shut off automatically.



- 10. Do not operate at temperatures below 25 degrees Fahrenheit.
- 11. Warning: To reduce the risk of electrical shock, unplug before cleaning or servicing.

Operation and User Maintenance:

Surface clean only, with a damp cloth.

Storage:

Store the Consumer Snow Machine in its plastic bag and box, if possible. Do not stack other boxes or items on top of the

Troubleshooting:

| | |
|--|---|
| Consumer Snow Machine isn't turning on | Insure that the correct power is applied to the Consumer Snow Machine |
| Turns on, but does not make snow – pump is noisy | Insure that the proper mixture of fluid is in the reservoir and that the reservoir is full. |
| Poor quality snow | Insure that the snow fluid is mixed in the proper ratio. |

If you have problems with your snow machine operation, please call (00-1) 256.229.5551 for 24 hour technical support.

Limited One Year Warranty

The Snowman is covered by a limited ONE-YEAR warranty for manufacturing defects related to the power cord, pump and fan when used in non-commercial application. Any misuse, abuse, or negligence automatically voids our warranty. The use of any liquids or materials other than water and approved Global Special Effects solutions automatically voids this warranty. Global Special Effects is not responsible for incidental or consequential damages and liability is limited to repair or replacement of the Snowman at Global Special Effects' sole discretion. Global Special Effects is not responsible for physical damage, scratching, tube damage, after shipping from Global Special Effects' manufacturing facility. This warranty excludes all costs of shipping and related expenses.

